

The image shows a close-up view of industrial filtration equipment. It features several large, horizontal, cylindrical metal filter housings with flanges, mounted on a blue-painted metal frame. Above the filter housings, there are vertical, conical metal components, likely part of a dust collector system. The background shows a white corrugated metal roof and a green hillside under a clear sky. The overall scene is an outdoor industrial setting.

# KROSTECH

CZECH PRODUCER OF  
FILTRATION SYSTEMS  
DUST COLLECTORS

# GENERAL INFORMATION

## PRODUCTION RANGE

RADIAL FANS
FILTER UNITS
FILTER UNITS FOR BRIQUETTING PRESS
DUST COLLECTORS
DAMPERS

## SALES RANGE

SAWDUST EXTRACTORS
SPRAY BOOTHS
BRIQUETTING PRESSES
DUCT SYSTEMS COMPONENTS

We influenced the market for industrial filtration and extraction by developing **highly efficient transport radial fans** in 1996. This been the way we opened independent business and by gradual, natural development, maintained control over the quality of our production.

An **individual approach** to every customer was **a key element** for further development, innovation **of our business** and expansion of the production range.

Nowadays we are carrying out dozens of installations of our machines and our designed dust extraction systems every year. Our projects, driven by customer requirements, pushing us to produce machines **with the parameters of the European top**.

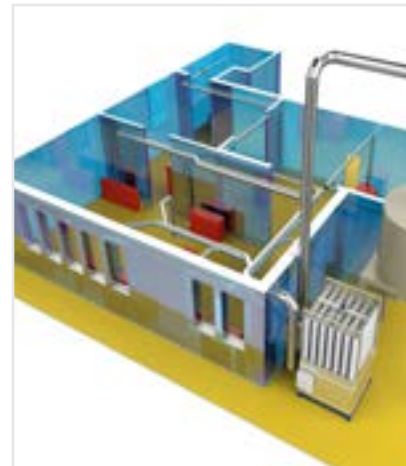

## COOPERATION PROCES

### 1. CONSULTATION

Email/telephone / personal discussion with the client. Definition of the problem and requirements for its solution. Specification of the future development of the client and his needs.

### 2. PROPOSAL

Solution variants resulting from the consultation. Price calculation of machine design, air conditioning, installation and transport.

### 3. PRODUCTION

Production of machines and air ducts tailored to customer requirements and capabilities.

### 4. REALIZATION

Assembly of machines. Installation of ventilation ducts. Connection of machines and their commissioning. Machine operator training.

### CUSTOMIZED SOLUTIONS

#### MATERIALS FROM THE CLIENT

- Problem specification.  
Basic information about workplace.  
Simple sketch of the space:
- Location of machines
  - Ceiling height
  - Free space to place the extractor
  - Idea of extraction duct system \*
  - Photos \*

*\*if possible*





# RADIAL FANS

## CF 280-3/CF 315-4

## CF 315-7,5 / CF 355-9/ CF 400-11

CHARACTERISTICS	PARAMETERS
<b>Vacuum(max):</b>	3 000 Pa
<b>Flow rate(max):</b>	6 820 - 8800 m <sup>3</sup> /h
<b>Suction diameter:</b>	280 - 315 mm
<b>Voltage:</b>	400 V/50 Hz
<b>Power engine:</b>	3 - 4 kW
<b>Nominal current:</b>	6,2 A
<b>Noise level:</b>	76 - 79 dB
<b>Weight:</b>	83 - 85 kg

### DIMENSION OF MACHINE

<b>Height:</b>	700 mm
<b>Width:</b>	700 mm
<b>Length:</b>	800 mm

CHARACTERISTICS	PARAMETERS
<b>Vacuum(max):</b>	4 850 - 5 400Pa
<b>Flow rate(max):</b>	9 600 -14 000m <sup>3</sup> /h
<b>Suction diameter:</b>	315 - 400 mm
<b>Voltage:</b>	400 V/50 Hz
<b>Power engine:</b>	7,5- 11 kW
<b>Nominal current:</b>	13,2 - 20,3 A
<b>Noise level:</b>	83- 85dB
<b>Weight:</b>	170 kg

### DIMENSION OF MACHINE

<b>Height:</b>	850 mm
<b>Width:</b>	870 mm
<b>Length:</b>	960 mm





# RADIAL FANS CHART

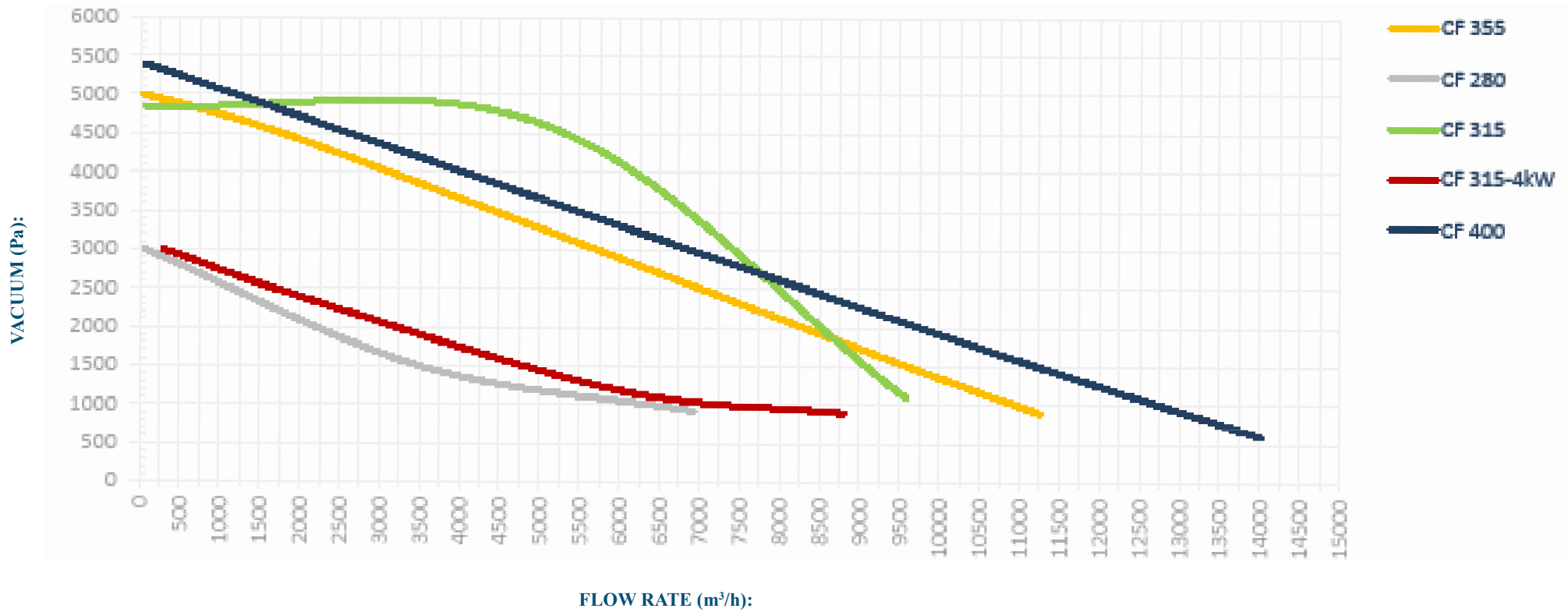

Filtration systems suitable as central extraction of large-area cutting centers, grinding and machining centers (CNC), brushing lines, etc. They are most often used for extraction of dust, chips, sawdust, shavings and small waste in woodworking machines.

**Thanks to compact dimensions, those machines meet the needs of carpentry, joinery workshops, etc.**

**MATERIAL** - wood and other composites (fabrics, foams), plastics

**INDUSTRY** - Woodworking, Construction, Engineering, Automotive, Metallurgical, Glass, Textile, Food...

**RADIAL FAN VARIANTS:**

<b>CF 280-3</b>	
<b>Vacuum (max):</b>	3 000 Pa
<b>Flow rate(max):</b>	6 200 m <sup>3</sup> /h
<b>Suction diameter:</b>	280 mm
<b>Power engine:</b>	3 Kw

<b>CF 315-4</b>	
<b>Vacuum (max):</b>	3 000 Pa
<b>Flow rate(max):</b>	8 800 m <sup>3</sup> /h
<b>Suction diameter:</b>	315 mm
<b>Power engine:</b>	4 Kw

## FILTER UNITS COMPACT SOLUTION

### FU-15

CHRARACTERISTICS	PARAMETERS
<b>Filter area:</b>	15 m <sup>2</sup>
<b>Volume of waste:</b>	0,47 m <sup>3</sup>
<b>Weight:</b>	100 kg

#### DIMENSION OF MACHINE

<b>Height:</b>	2 850 mm
<b>Width:</b>	810 mm
<b>Length:</b>	2 130 mm

### FU-30R

CHRARACTERISTICS	PARAMETERS
<b>Filter area:</b>	34 m <sup>2</sup>
<b>Volume of waste:</b>	0,9 m <sup>3</sup>
<b>Weight:</b>	250kg

#### DIMENSION OF MACHINE

<b>Height:</b>	3 200 mm
<b>Width:</b>	1 200 mm
<b>Length:</b>	3 000 mm

#### Filter regeneration:

**BY ROD** - works mechanically by a hand pull

**BUTTON** - works as long as the button is pressed

**AUTOMATIC** - automatic cleaning sequence after switching off the fan

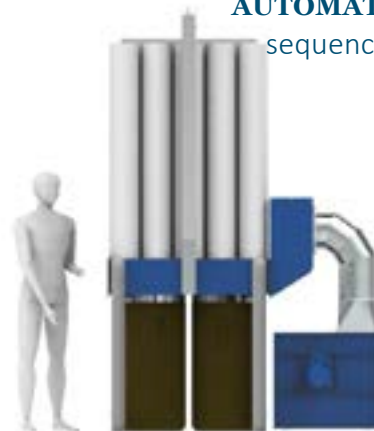

#### Filter regeneration:

**BUTTON** - works as long as the button is pressed

**AUTOMATIC** - automatic cleaning sequence after switching off the fan





HÖLZNER

CNC CENTER - (CZECH)



RADIAL FAN VARIANTS FOR FU-30:

**CF 280-3**

Vacuum (max):	3 000 Pa
Flow rate(max):	6 200 m <sup>3</sup> /h
Suction diameter:	280 mm
Power engine:	3 Kw

**CF 315-4**

Vacuum (max):	3 000 Pa
Flow rate(max):	8 800 m <sup>3</sup> /h
Suction diameter:	315 mm
Power engine:	4 Kw

FOR FU 50/ FU-58R/FU-85R:

**CF 315-7.5**

Vacuum (max):	4 800 Pa
Flow rate(max):	9 600 m <sup>3</sup> /h
Suction diameter:	315 mm
Power engine:	7,5 Kw

**CF 355-9.2**

Vacuum (max):	5 000 Pa
Flow rate(max):	11 200 m <sup>3</sup> /h
Suction diameter:	355 mm
Power engine:	9,2 Kw

**CF 400-11**

Vacuum (max):	5 400 Pa
Flow rate(max):	14 000 m <sup>3</sup> /h
Suction diameter:	400 mm
Power engine:	11 Kw

**FILTER UNITS** STANDART SOLUTION

**FU-30 / FU-50**

**FU-58R/FU-85R**

CHRARACTERISTICS	PARAMETERS
Filter area:	30-50 m <sup>2</sup>
Volume of waste:	0,95 m <sup>3</sup>
Weight:	200-300 kg

DIMENSION OF MACHINE	
Height:	2 850-3 850 mm
Width:	810 mm
Length:	3 330 mm

CHRARACTERISTICS	PARAMETERS
Filter area:	58-85 m <sup>2</sup>
Volume of waste:	0,9 -1,7m <sup>3</sup>
Weight:	250-400 kg

DIMENSION OF MACHINE	
Height:	3 200-4 400 mm
Width:	1 200 mm
Length:	4 300-5 000 mm



**Filter regeneration:**

**BUTTON** - works as long as the button is pressed

**AUTOMATIC** - automatic cleaning sequence after switching off the fan

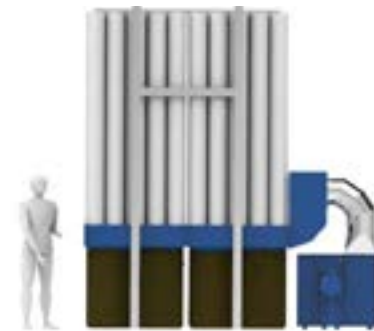

**Filter regeneration:**

**BUTTON** - works as long as the button is pressed

**AUTOMATIC** - automatic cleaning sequence after switching off the fan



Filtration systems with automatic filter regeneration, for continuous emptying of waste without swirling of dust caused by the fan.

The units ensure continuous pressure-less emptying of waste and maintain warm air in the workplace. **The waste can be transported** to a tank, open container, etc. **without heat loss.**

**MATERIAL** - wood and other composites (fabrics, foams) metal, stone, glass, plastics

**INDUSTRY** - Construction, Engineering, Automotive, Metallurgical, Glass, Textile, Food...

**RADIAL FAN VARIANTS:**

### CF 315-7.5

<b>Vacuum (max):</b>	4 800 Pa
<b>Flow rate(max):</b>	9 600 m3/h
<b>Suction diameter:</b>	315 mm
<b>Power engine:</b>	7,5 Kw

### CF 355-9.2

<b>Vacuum (max):</b>	5 000 Pa
<b>Flow rate(max):</b>	11 200 m3/h
<b>Suction diameter:</b>	355 mm
<b>Power engine:</b>	9,2 Kw

### CF 400-11

<b>Vacuum (max):</b>	5 400 Pa
<b>Flow rate(max):</b>	14 000 m3/h
<b>Suction diameter:</b>	400 mm
<b>Power engine:</b>	11 Kw

## FILTER UNITS WITH CONTINUOUS EMPTYING

### FUS-50

CHARACTERISTICS	PARAMETERS
<b>Filter area:</b>	50 m <sup>2</sup>
<b>Weight:</b>	950 kg

#### DIMENSION OF MACHINE

<b>Height:</b>	3 400 mm
<b>Width:</b>	1 300 mm
<b>Length:</b>	4 500 mm

### FUS-85

CHARACTERISTICS	PARAMETERS
<b>Filter area:</b>	85 m <sup>2</sup>
<b>Weight:</b>	1 100 kg

#### DIMENSION OF MACHINE

<b>Height:</b>	4 400 mm
<b>Width:</b>	1 300 mm
<b>Length:</b>	4 500 mm

### Filter regeneration:

**AUTOMATIC** - automatic cleaning sequence after switching off the fan

### Filter regeneration:

**AUTOMATIC** - automatic cleaning sequence after switching off the fan







Kros  
KROSA

WOOD PRODUCTION - (CZECH)



Machines designed for **large amounts of non-explosive non-sticky dust, small waste and fumes**. They are used as central dust extraction of grinding tables, blasting booths, milling and grinding machines, CNC milling machines, etc. Suitable for exhaustion of plasma and laser milling machines.

Cartridge **filters**, made of polyester or **with PTFE membrane, are cleaned by automatic regeneration**.

**MATERIAL** - metal, stone, glass, plastics, composites (wood, fabrics, foams...)

**INDUSTRY** - Construction, Engineering, Automotive, Metallurgical, Glass, Textile, Food

Suitable for:

**WELDING** - Plasma, laser, electron beam...

**MACHINING** - Cutting, Milling, Drilling, Turning, Grinding, Engraving, Lapping...

**SURFACE TREATMENT** - Polishing, Lapping, Pickling, Cementing, Metallization, Painting...

**RADIAL FAN VARIANT:**

<b>CF 150-3</b>	
<b>Vacuum (max):</b>	3 000 Pa
<b>Flow rate(max):</b>	2 100 m <sup>3</sup> /h
<b>Suction diameter:</b>	150 mm
<b>Power engine:</b>	400 V/50Hz
<b>Výkon motoru:</b>	3 Kw

# DUST COLLECTORS COMPACT SOLUTION

## FUP-20

### CHARACTERISTICS

CHARACTERISTICS	PARAMETERS
<b>Filter area:</b>	20 m <sup>2</sup>
<b>Volume of waste:</b>	0,126 m <sup>3</sup>
<b>Weight:</b>	220 kg

### DIMENSION OF MACHINE

<b>Height:</b>	2 000 mm
<b>Width:</b>	1 100 mm
<b>Length:</b>	1 400 mm



### Filter regeneration:

**AUTOMATIC** - automatic sequence of cleaning by pulse flushing (compressed air)



RADIAL FAN VARIANTS FOR FUP-120:

CF 280-3	
Vacuum (max):	3 000 Pa
Flow rate(max):	6 200 m3/h
Suction diameter:	280 mm
Power engine:	3 Kw

CF 315-4	
Vacuum (max):	3 000 Pa
Flow rate(max):	8 800 m3/h
Suction diameter:	315 mm
Power engine:	4 Kw

FOR FUP-160R/190R:

CF 315-7.5	
Vacuum (max):	4 800 Pa
Flow rate(max):	9 600 m3/h
Suction diameter:	315 mm
Power engine:	7,5 Kw

CF 355-9.2	
Vacuum (max):	5 000 Pa
Flow rate(max):	11 200 m3/h
Suction diameter:	355 mm
Power engine:	9,2 Kw

CF 400-11	
Vacuum (max):	5 400 Pa
Flow rate(max):	14 000 m3/h
Suction diameter:	400 mm
Power engine:	11 Kw

# DUST COLLECTORS

STANDART SOLUTION

## FUP-120R

## FUP-160R / FUP-190R

CHRRACTERISTICS	PARAMETERS
Filter area:	120 m <sup>2</sup>
Volume of waste:	0,22 m <sup>3</sup>
Weight:	350 kg

DIMENSION OF MACHINE	
Height:	2 800 mm
Width:	1 100 mm
Length:	3 100 mm

CHRRACTERISTICS	PARAMETERS
Filter area:	160-190 m <sup>2</sup>
Volume of waste:	0,44 m <sup>3</sup>
Weight:	950-1 100 kg

DIMENSION OF MACHINE	
Height:	4 000 mm
Width:	1 350 mm
Length:	3 800 mm

### Filter regeneration:

**AUTOMATIC** - automatic sequence of cleaning by pulse flushing (compressed air)

### Filter regeneration:

**AUTOMATIC** - automatic sequence of cleaning by pulse flushing (compressed air)







(EXPLOSIVE SOLUTION) MANUFACTURE OF AERONAUTICAL COMPOSITES - (RUSSIA)





These machines are mainly suitable for the central extraction of a workplace. Used for the **recovery of waste** in the form of **high-calorific wood briquettes**.

**RADIAL FAN VARIANTS:**

**CF 280-3**

<b>Vacuum (max):</b>	3 000 Pa
<b>Flow rate(max):</b>	6 200 m <sup>3</sup> /h
<b>Suction diameter:</b>	280 mm
<b>Power engine:</b>	3 Kw

**CF 315-4**

<b>Vacuum (max):</b>	3 000 Pa
<b>Flow rate(max):</b>	8 800 m <sup>3</sup> /h
<b>Suction diameter:</b>	315 mm
<b>Power engine:</b>	4 Kw

**CF 315-4**

<b>Vacuum (max):</b>	3 000 Pa
<b>Flow rate(max):</b>	8 800 m <sup>3</sup> /h
<b>Suction diameter:</b>	315 mm
<b>Power engine:</b>	4 Kw

**CF 315-7.5**

<b>Vacuum (max):</b>	4 800 Pa
<b>Flow rate(max):</b>	9 600 m <sup>3</sup> /h
<b>Suction diameter:</b>	315 mm
<b>Power engine:</b>	7,5 Kw

**CF 355-9.2**

<b>Vacuum (max):</b>	5 000 Pa
<b>Flow rate(max):</b>	11 200 m <sup>3</sup> /h
<b>Suction diameter:</b>	355 mm
<b>Power engine:</b>	9,2 Kw

**FILTER UNITS FOR BRIQUETTING PRESSES**

**FUB- 21 / FUB-35**

**FUB-60**

CHARACTERISTICS	PARAMETERS
<b>Filter area:</b>	21-35m <sup>2</sup>
<b>Volume of waste:</b>	1 m <sup>3</sup>

CHARACTERISTICS	PARAMETERS
<b>Filter area:</b>	60 m <sup>2</sup>
<b>Volume of waste:</b>	1 m <sup>3</sup>

**DIMENSION OF MACHINE**

<b>Height:</b>	1 700-2 700mm
<b>Height with briquetting presses:</b>	2 900-3 900mm
<b>Width:</b>	1 270 mm
<b>Length:</b>	2 600 mm

**DIMENSION OF MACHINE**

<b>Height:</b>	2 800 mm
<b>Height with briquetting presses:</b>	3 500 mm
<b>Width:</b>	2 000 mm
<b>Length:</b>	3 100 mm

**Filter regeneration:**  
**AUTOMATIC** - automatic cleaning sequence after switching off the fan

**Filter regeneration:**  
**AUTOMATIC** - automatic cleaning sequence after switching off the fan



RADIAL FAN VARIANTS FOR FUB-602X:

CF 280-3	
Vacuum (max):	3 000 Pa
Flow rate(max):	6 200 m <sup>3</sup> /h
Suction diameter:	280 mm
Power engine:	3 Kw

CF 315-4	
Vacuum (max):	3 000 Pa
Flow rate(max):	8 800 m <sup>3</sup> /h
Suction diameter:	315 mm
Power engine:	4 Kw

FOR FUB-982X:

CF 315-7.5	
Vacuum (max):	4 800 Pa
Flow rate(max):	9 600 m <sup>3</sup> /h
Suction diameter:	315 mm
Power engine:	7,5 Kw

CF 355-9.2	
Vacuum (max):	5 000 Pa
Flow rate(max):	11 200 m <sup>3</sup> /h
Suction diameter:	355 mm
Power engine:	9,2 Kw

# FILTER UNITS WITH DOUBLE POWER FOR BRIQUETTING PRESSES

## FUB- 60 2X

## FUB-98 2X

CHARACTERISTICS	PARAMETERS
Filter area:	60 m <sup>2</sup>
Volume of waste:	1 m <sup>3</sup>

CHARACTERISTICS	PARAMETERS
Filter area:	98 m <sup>2</sup>
Volume of waste:	3 m <sup>3</sup>

DIMENSION OF MACHINE	
Height:	2 800 mm
Height with briquetting presses:	4 000 mm
Width:	2 100 mm
Length:	4 300 mm

DIMENSION OF MACHINE	
Height:	2 700 mm
Height with briquetting presses:	3 900 mm
Width:	2 500 mm
Length:	5 000 mm

**Filter regeneration:**  
**AUTOMATIC** - automatic cleaning sequence after switching off the fan

**Filter regeneration:**  
**AUTOMATIC** - automatic cleaning sequence after switching off the fan





**WINDOWS AND DOORS MANUFACTURE(CZECH)**



Cyklone is designed to capture larger particles of waste during extraction. The separator proves to be a **pre-separation** before the main filtration, **it catches up to 97% of waste**, which is able to ensure the **extension of the filter life**.

# CYCLONE SEPARATORS

## CS 280/CS 315/ CS355

### CHARACTERISTICS

CHARACTERISTICS	PARAMETERS
<b>Flow rate:</b>	up to 11 200 m <sup>3</sup> /h
<b>Capacity of rotary valve :</b>	4 m <sup>3</sup> /h

### DIMENSION OF MACHINE

<b>Height:</b>	3 800 mm
<b>Width:</b>	1 800 mm
<b>Length:</b>	1 700 mm

### RADIAL FAN VARIANTS:

#### CF 280-3

<b>Vacuum (max):</b>	3 000 Pa
<b>Flow rate(max):</b>	6 200 m <sup>3</sup> /h
<b>Suction diameter:</b>	280 mm
<b>Power engine:</b>	3 Kw

#### CF 315-4

<b>Vacuum (max):</b>	3 000 Pa
<b>Flow rate(max):</b>	8 800 m <sup>3</sup> /h
<b>Suction diameter:</b>	315 mm
<b>Power engine:</b>	4 Kw

#### CF 315-7.5

<b>Vacuum (max):</b>	4 800 Pa
<b>Flow rate(max):</b>	9 600 m <sup>3</sup> /h
<b>Suction diameter:</b>	315 mm
<b>Power engine:</b>	7,5 Kw

#### CF 355-9.2

<b>Vacuum (max):</b>	5 000 Pa
<b>Flow rate(max):</b>	11 200 m <sup>3</sup> /h
<b>Suction diameter:</b>	355 mm
<b>Power engine:</b>	9,2 Kw



### HORIZONTÁLNÍ VARIANTA







**IZOLATION BOARDS MANUFACTURE-(SLOVAKIA)**







## ATYPICAL DESIGN

- CUSTOMIZE SOLUTION
- DESIGN OPTIMATIZATION
- STRUCTURE MODIFICATION



## SAVINGS AND EFFICIENCY

- AUTOMATIC START
- CONTROLLED FLOW
- CONTINUOUS EMPTYING

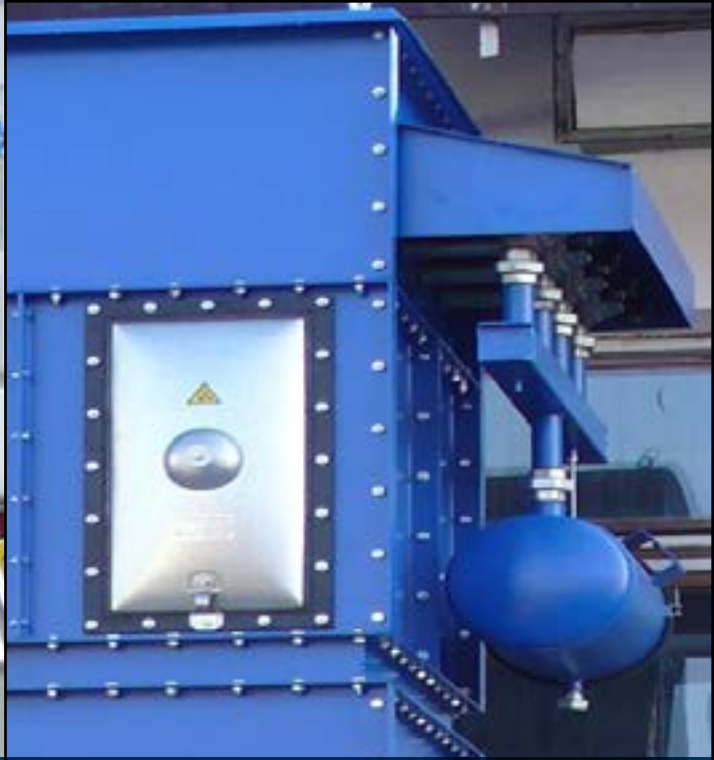

## CRISIS SECURITY

- WOOD CHIPS CATCHERS
- SPARK CATCHERS
- ATEX EXPLOSION PROTECTION





# KROSTECH

## ADDITIONAL INFORMATION

**Catalog validity:** January 2020

**Warranty period of machines:**

Unless otherwise stated, the products we offer are covered by the statutory warranty period of 24 months.

**Delivery time:**

Depending on the availability of materials and parts in stock, it varies from machine to machine. From stock are machines usually shipped in 1-2 weeks, otherwise up to 9 weeks. This delivery time does not apply to atypical tailor-made machines.

### BUSINESS DATA

KROSTECH s.r.o.

**Address:** Lyzbice 135, Trinec 739 61

**VAT:** CZ06734006

### CONTACT

**Jana Raskova**

e-mail: [raskova@krostech.cz](mailto:raskova@krostech.cz)

tel: +420 774 222 547